

DESCRIPTION AND OPERATION

TRANSFER CASE

The Borg-Warner 44-06 manual shift and electrical shift transfer cases are a three-piece magnesium design. The unit transfers engine power from the transmission to the front and rear axles. Under normal driving conditions the unit is in two-wheel drive high (2H) but when desired the operator may shift into four-wheel drive high (4H) or four-wheel drive low (4L). The operator may shift from 2H to 4H or from 4H to 2H at any speed up to 88 km/h (55 mph). The vehicle must be stopped to shift into 4L. The transfer case is shifted either manually or electronically. The unit is lubricated by a positive displacement fluid pump that channels fluid flow through drilled holes in the rear output shaft.

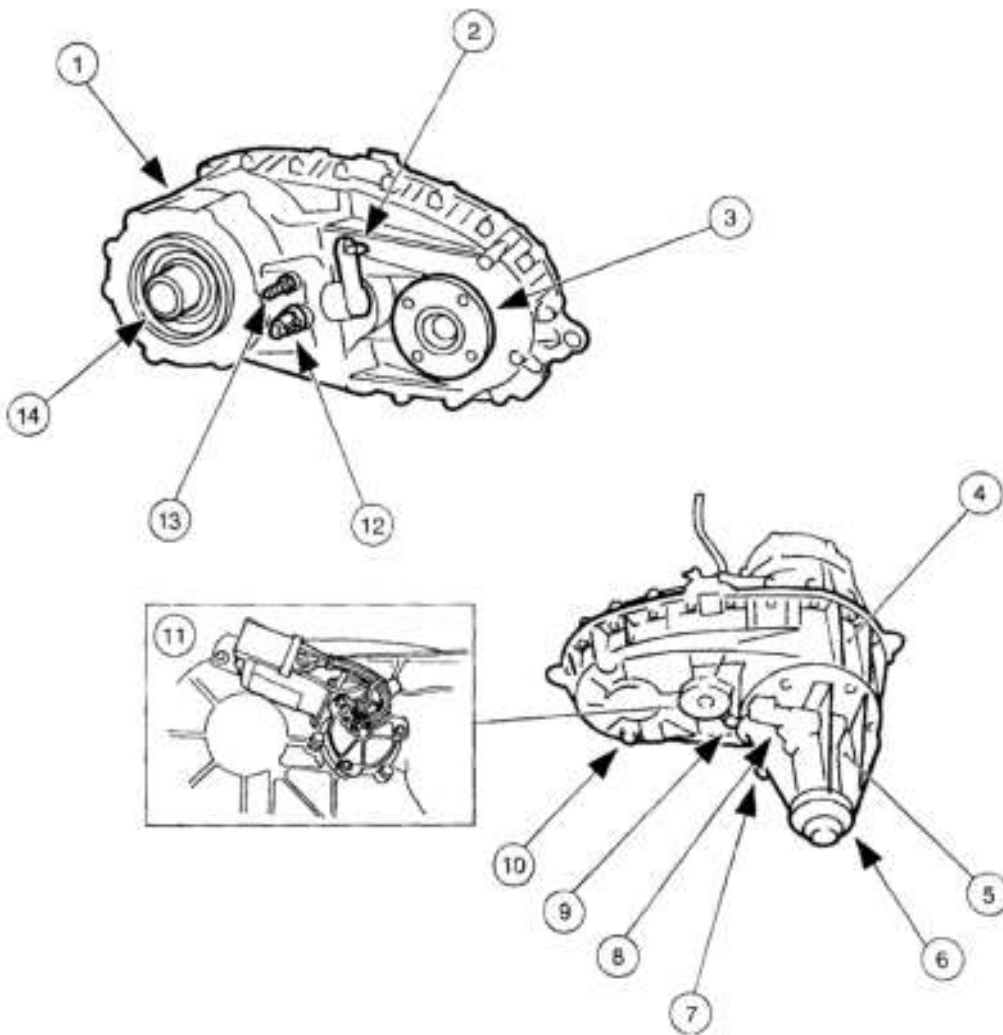

Item	Part Number	Description
1	7A195	Transfer case
2	7B106	Shift lever (manual shift only)
3	7161	Front output shaft
4	7005	Case
5	7085	Extension housing
6	7061	Output shaft
7	—	Coil electrical connector (manual shift only)

Item	Part Number	Description
8	—	Output shaft speed sensor (OSS) (part of 7085)
9	7A010	Case plug fill
10	7A010	Case plug drain
11	7G360	Transfer case shift motor (electric shift only)
12	7E440	4WD indicator switch (manual shift only)
13	7034	Breather barb
14	—	Input shaft

G021-48918

Fig. 1: Transfer Case External Components

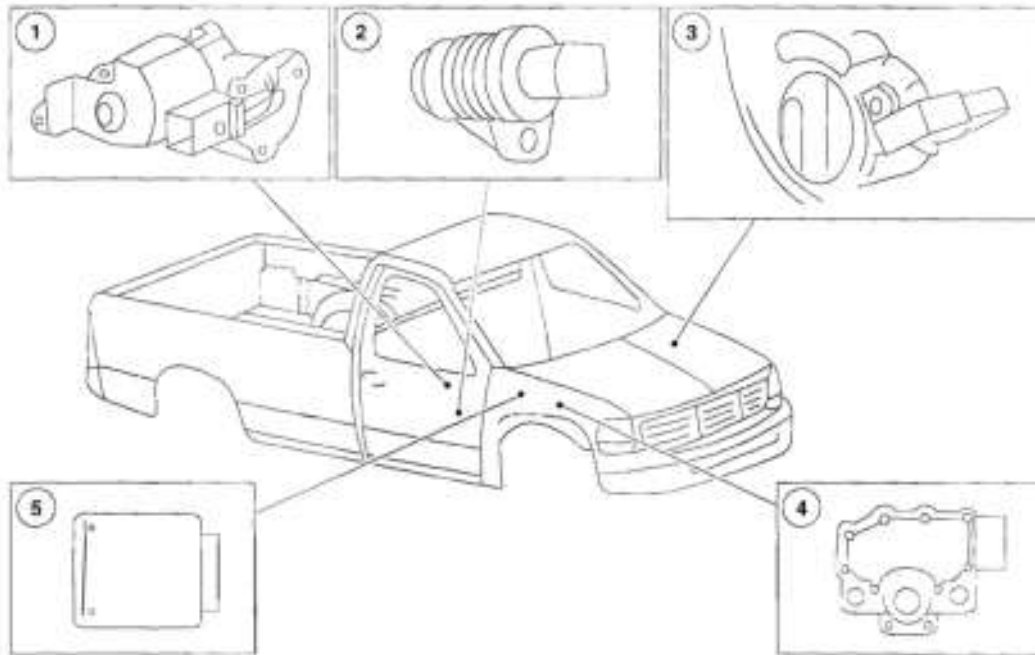

Item	Part Number	Description
1	7G360	Transfer case shift motor (electric shift only)
2	—	Output shaft speed sensor (OSS) (manual shift only)
3	—	Shift range selector switch (electric shift only)

Item	Part Number	Description
4	—	Transmission range (TR) sensor (automatic transmission only)
5	—	Generic electronic module (GEM) (electric shift only)

002148916

Fig. 2: Electronic Shift Control System Components