

IN-VEHICLE REPAIR

TRANSFER CASE REAR OUTPUT SHAFT SEAL

Special Tool(s)

SPECIAL TOOL REFERENCE

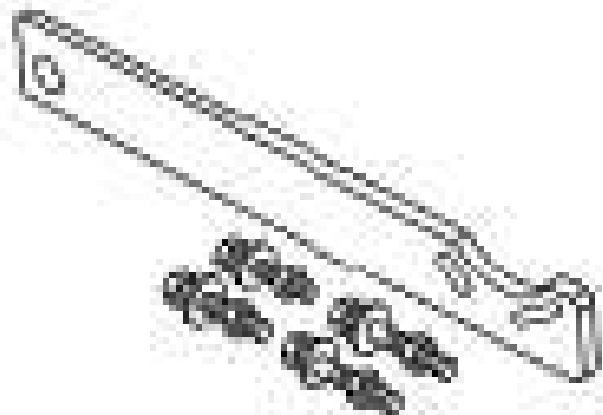

ST1257-A

Holding Fixture, Drive Pinion Flange 205-126 (T78P-4851-A)

Installer, Drive Pinion Oil Seal 205-304 (T90T-4676-A)

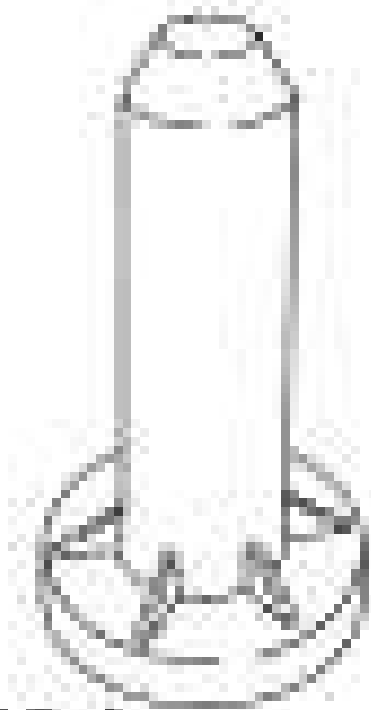

ST2519-A



ST2518-A

Installer, Transmission Output Shaft Flange
205-495

Remover, Oil Seal 303-409 (T92C-6700-CH)

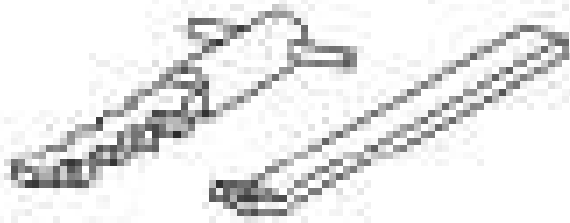

ST1385-A

Material

ITEM SPECIFICATION

Item	Specification
Threadlock 262 TA-26	WSK-M2G351-A6

Rear Output Shaft Seal - Exploded View

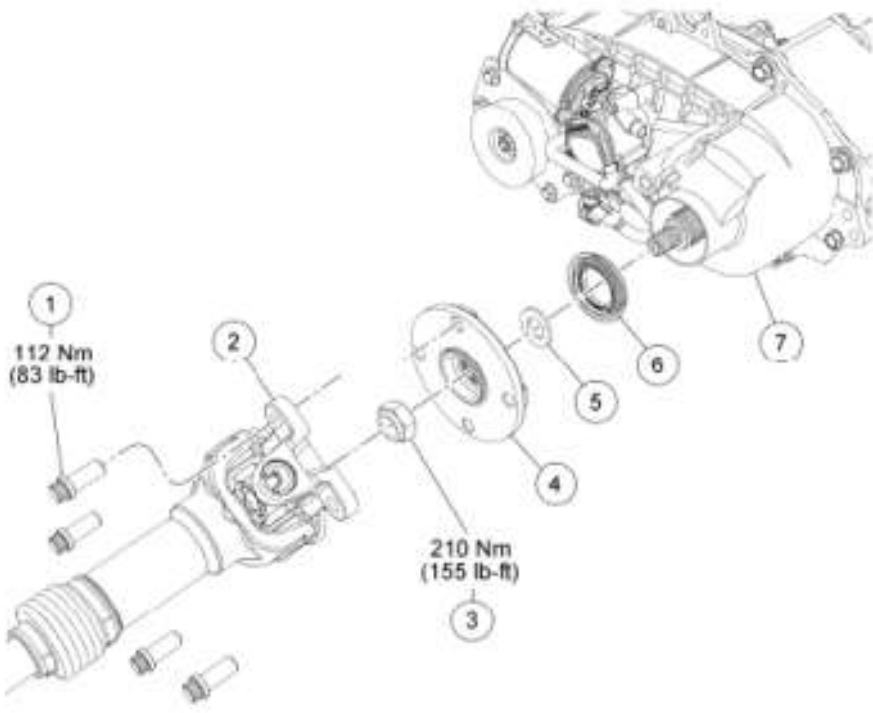

N0070971

Fig. 4: Exploded View Of Rear Output Shaft Seal With Torque Specifications
 Courtesy of FORD MOTOR CO.

ITEM DESCRIPTION

--	--	--

Item	Part Number	Description
1	-	Driveshaft bolt (4 required)
2	4602	Driveshaft
3	7045	Nut
4	7B214	Flange
5	7B368	Washer
6	7B215	Rear output shaft seal
7	-	Transfer case

Removal

1. With the vehicle in NEUTRAL, position it on a hoist. For additional information, refer to **JACKING AND LIFTING** .

NOTE: Index-mark the front flange on the rear driveshaft and the flange on the transfer case.

- 2.

Disconnect the rear driveshaft from the transfer case and position the driveshaft aside.

1. Index-mark the front flange on the driveshaft and the flange on the transfer case.
2. Remove and discard the 4 rear driveshaft-to-flange bolts.
3. Disconnect the driveshaft from the transfer case and position the driveshaft aside.



Fig. 5: Identifying Driveshaft, Flange And Transfer Case
Courtesy of FORD MOTOR CO.

3. **NOTE:** Index-mark the rear output shaft and the flange.

NOTE: The nut has a self-locking feature. Discard the nut and the washer after removing them.

Use the Drive Pinion Flange Holding Fixture to prevent the flange from turning. Remove and discard the flange nut and the washer.

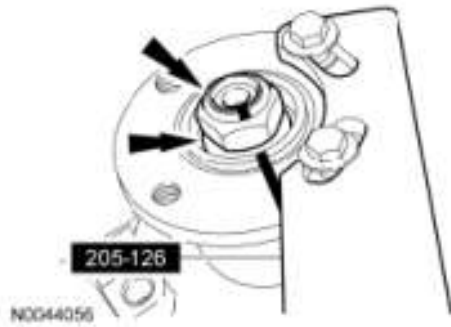

Fig. 6: Locating Flange Nut And Washer
Courtesy of FORD MOTOR CO.

4. Using a suitable puller and the Drive Pinion Flange Holding Fixture, remove the flange.

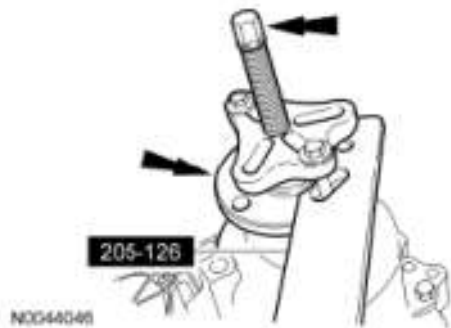

Fig. 7: Removing Flange Using Suitable Puller
Courtesy of FORD MOTOR CO.

5. Remove the oil seal if it remains on the rear output shaft.



Fig. 8: Locating Oil Seal On Rear Output Shaft
Courtesy of FORD MOTOR CO.

6. Using the Oil Seal Remover, remove the rear output shaft seal.

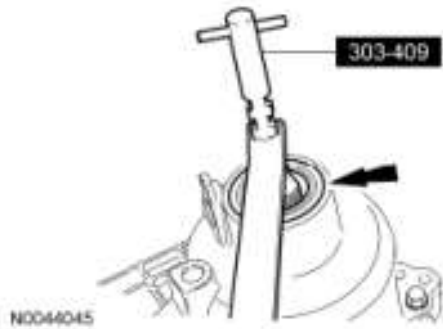

Fig. 9: Removing Rear Output Shaft Seal Using Oil Seal Remover
 Courtesy of FORD MOTOR CO.

Installation

1. Clean the seal mounting surface.
2. Using the Drive Pinion Oil Seal Installer, install a new rear output shaft seal.

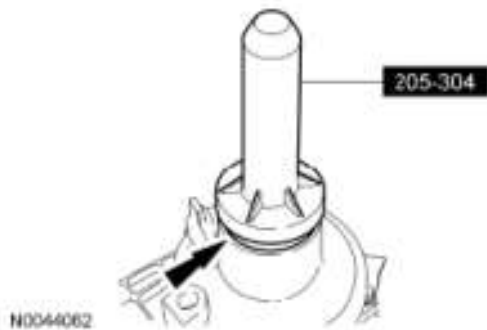

Fig. 10: Installing Rear Output Shaft Seal Using Drive Pinion Oil Seal Installer
 Courtesy of FORD MOTOR CO.

3. **NOTE: Align the index marks.**

NOTE: Verify the oil seal is not on the shaft before installing the flange.

Position the flange on the rear output shaft.

4. Install a new oil seal in the flange.
5. Using the Transmission Output Shaft Flange Installer, install the flange. Tighten the nut on the Transmission Output Shaft Flange Installer to 54 Nm (40 lb-ft) to seat the flange on the shaft.

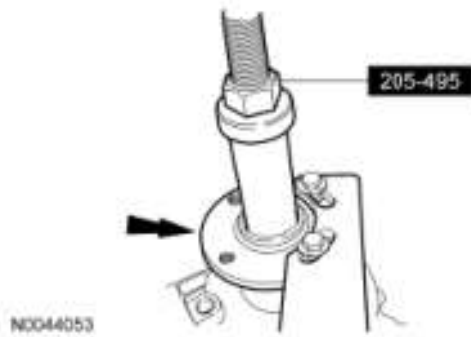

Fig. 11: Installing Flange Using Transmission Output Shaft Flange Installer
 Courtesy of FORD MOTOR CO.

6. Use the Drive Pinion Flange Holding Fixture to prevent the flange from turning. Install a new washer and a new flange nut.
 - Tighten to 210 Nm (155 lb-ft).

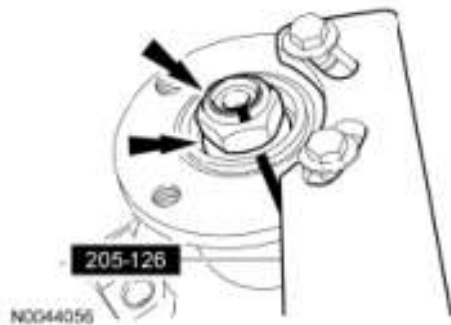

Fig. 12: Locating Washer And Flange Nut
 Courtesy of FORD MOTOR CO.

- NOTE:** **Align the index marks. Install the driveshaft with new bolts. If new bolts are not available, coat the threads of the original bolts with threadlock.**
- 7.

Connect the driveshaft to the transfer case and install the 4 rear driveshaft-to-flange bolts.

- Tighten to 112 Nm (83 lb-ft).



Fig. 13: Locating Driveshaft-To-Flange Bolts
 Courtesy of FORD MOTOR CO.

8. Check the transfer case fluid level. If necessary, fill the transfer case to the correct level with the specified fluid. For additional information, refer to **TRANSFER CASE DRAINING AND FILLING**.