

DISASSEMBLY AND ASSEMBLY

STEERING COLUMN

GENERAL EQUIPMENT

Pull Scale (30 pound capacity)

MATERIAL SPECIFICATION

Item	Specification
Premium Long Life Grease XG-1-C	ESA-M1C75-B

- 1. Remove the steering column. For additional information, refer to **STEERING COLUMN**.
- 2. Disassemble the parts in the order indicated in the following illustration and table.

To remove individual parts, only carry out the listed steps:

PARTS SPECIFICATION

Part	Steps
Tilt tension spring	1-2
Tilt lever	1,3-13
Shift cable/harness retainer brackets	15-17

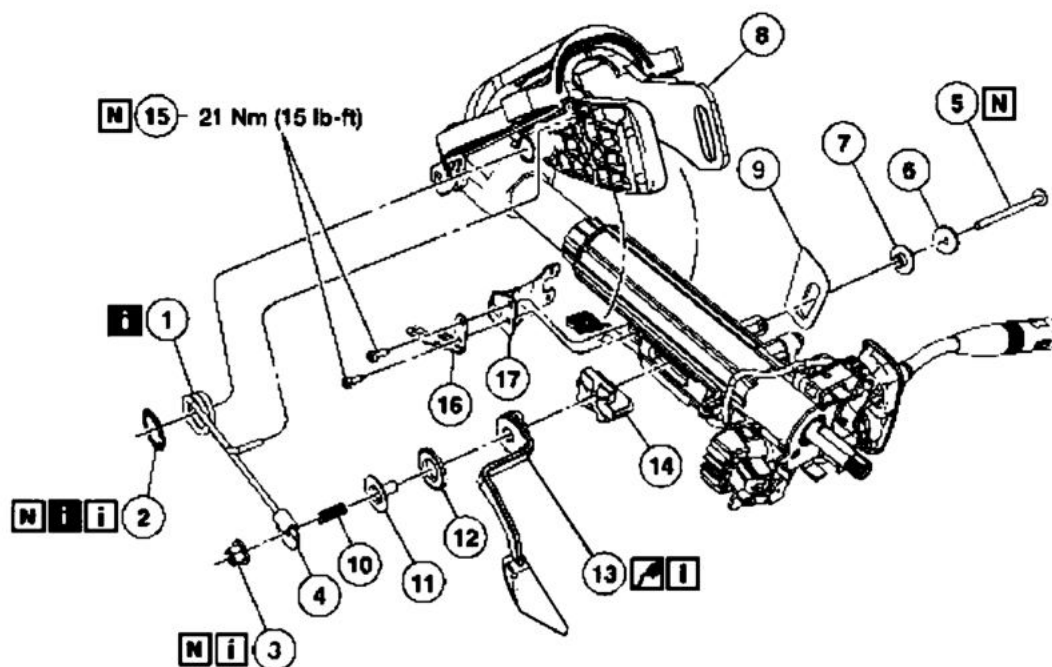

Item	Part Number	Description
1	3D655B	Tilt tension spring (release from hanger) Disassembly Note
2	3D686	Retainer clip Disassembly Note Assembly Note
3	W702058-S	Nut Assembly Note
4	3C650	Spring hanger
5	3K661	Pin
6	—	Washer
7	3E519	Sleeve washer
8	3N803	Support/tilt bracket (pivot upward)
9	3N653	Bushing
10	3D655A	Release lever spring
11	3E519	Sleeve washer
12	—	Bearing
13	3B661	Tilt lever Assembly Note
14	7D672	Clamp plate
15	N805858-S100	Bolts
16	14A206	Harness retainer bracket
17	7E364	Shift cable bracket

G03180407

Fig. 37: Identifying Removal Order Of Steering Column

Courtesy of FORD MOTOR CO.

3. To assemble, reverse the disassembly procedure.

Item 1: Tilt Tension Spring Disassembly Note

NOTE: To ease the removal of the spring, make sure that the column tilt assembly is in the upward position.

1. To release the tension, pull downward on the spring and route the spring above the spring hanger.

Item 2: Retainer Clip Disassembly Note

1. Using suitable cutters, remove the retainer clip and remove the spring.

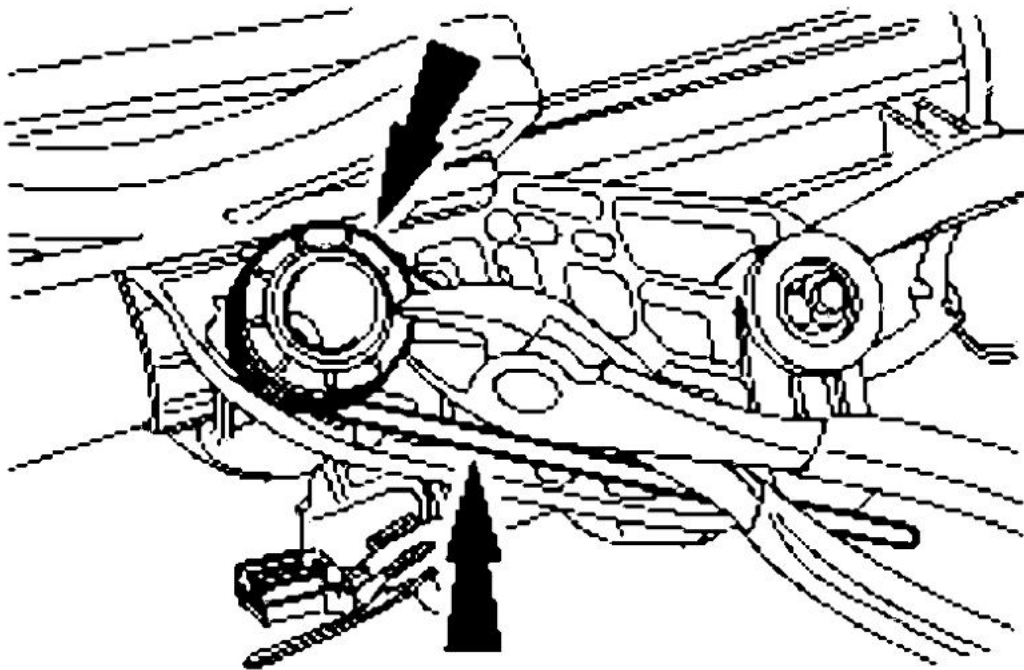

G03180408

Fig. 38: Removing Retainer Clip And Removing Spring
Courtesy of FORD MOTOR CO.

Item 13: Tilt Lever Assembly Note

1. Apply a small amount of grease to the tilt lever cam mating surface, making sure to fill the grooves.

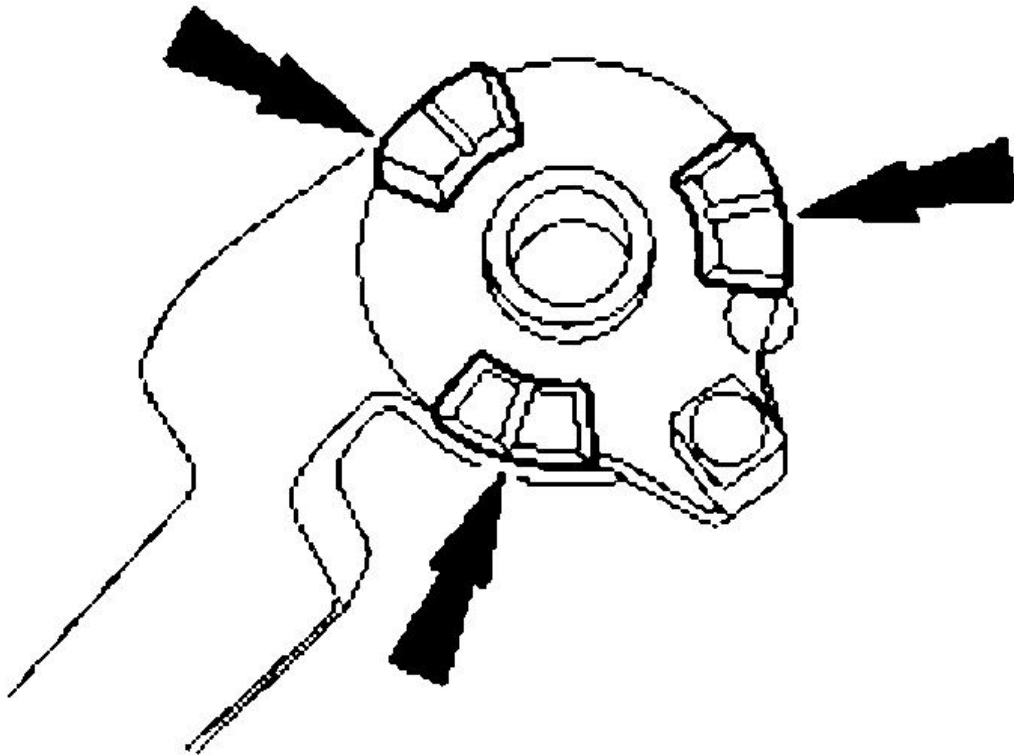

G03180409

Fig. 39: Identifying Tilt Lever Cam
Courtesy of FORD MOTOR CO.

Item 3: Nut Assembly Note

1. Attach a suitable pull scale with the capacity of 30 pounds to the end of the tilt lever and pull the lever into the locked position. Tighten or loosen the nut until 12-16 pounds is required to lock the lever.

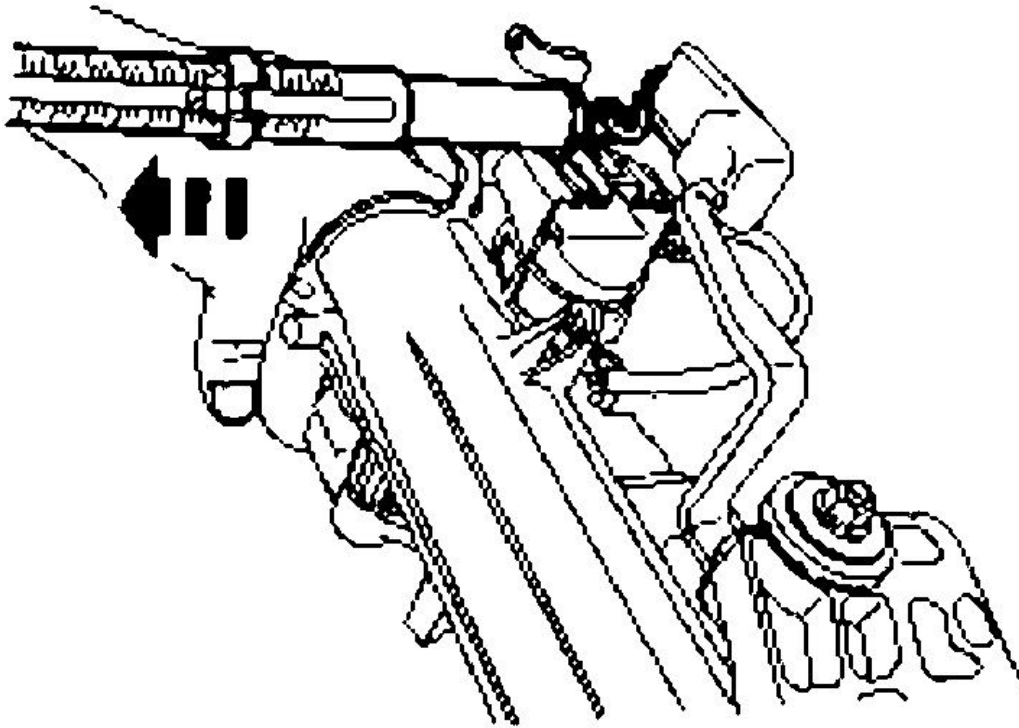

G03180410

Fig. 40: Attaching Suitable Pull Scale
Courtesy of FORD MOTOR CO.

Item 2: Retainer Clip Assembly Note

CAUTION: Make sure that the retainer is 4 mm (0.16 in) from the top of the post or damage can result.

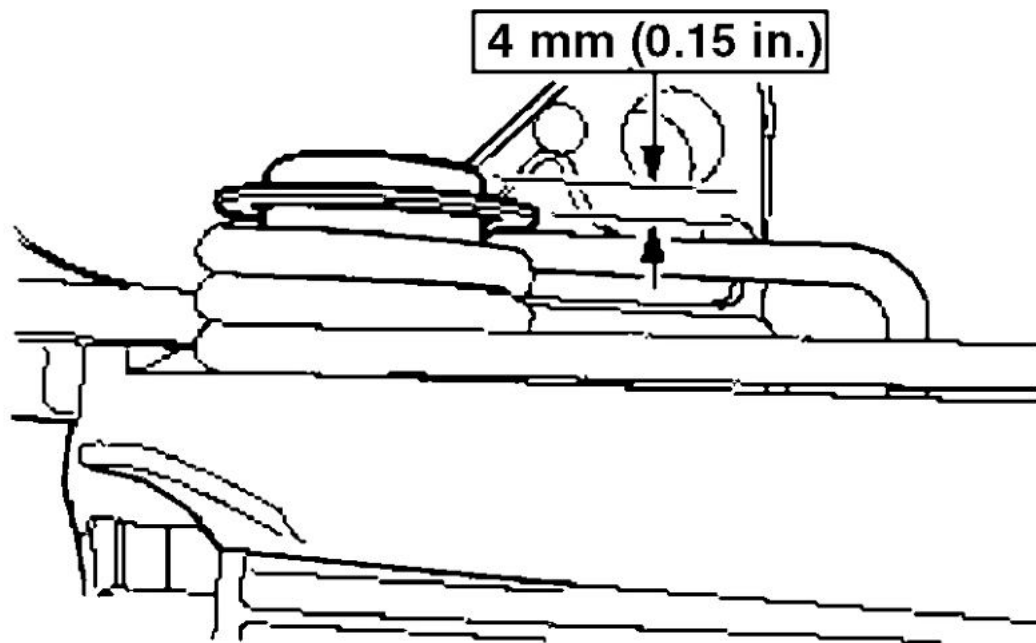

G03180411

Fig. 41: Installing Spring Retainer
Courtesy of FORD MOTOR CO.

1. Install the spring retainer.